

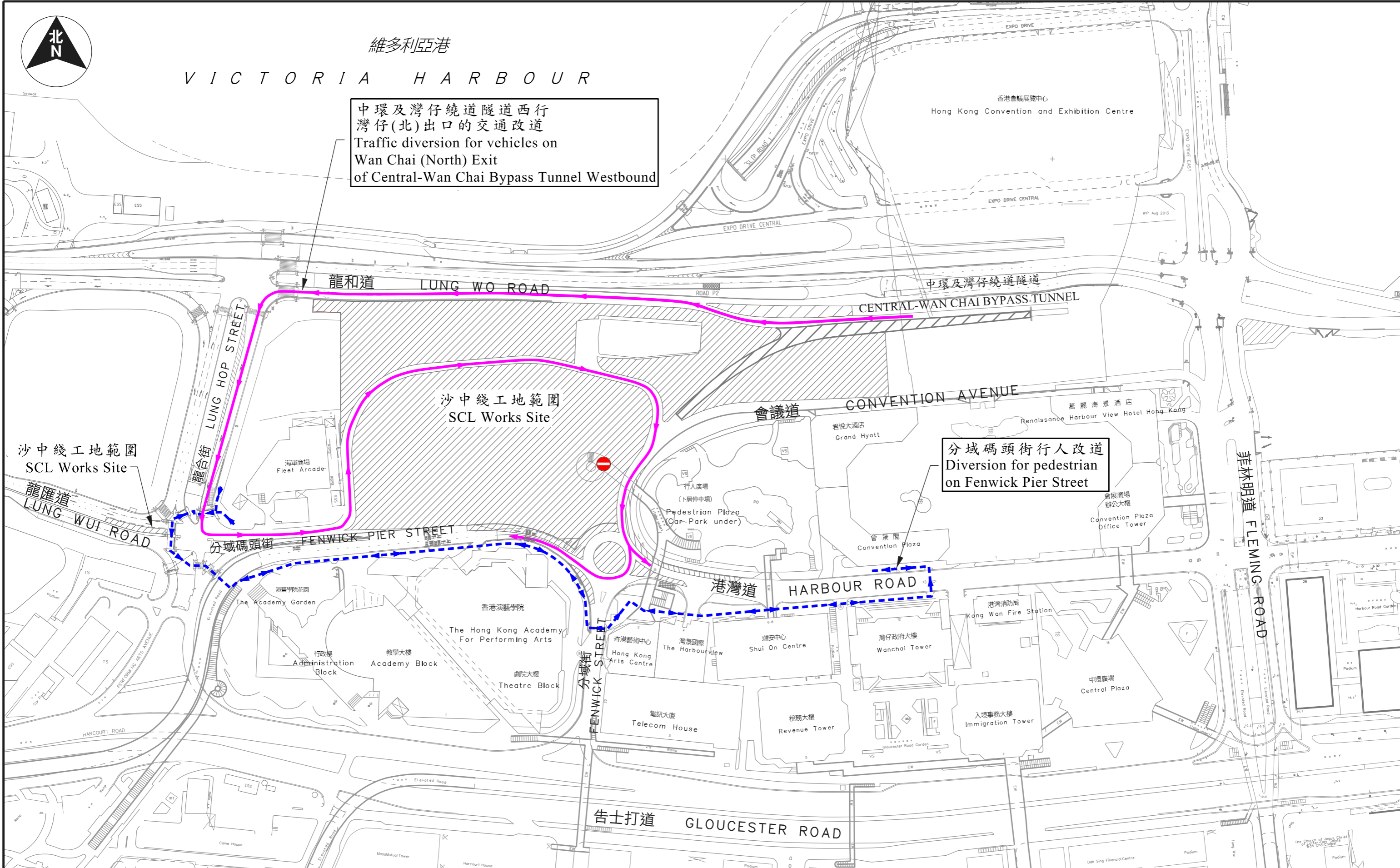

維多利亞港

VICTORIA HARBOUR

中環及灣仔繞道隧道西行  
灣仔(北)出口的交通改道  
Traffic diversion for vehicles on  
Wan Chai (North) Exit  
of Central-Wan Chai Bypass Tunnel Westbound



沙中綫工地範圍  
SCL Works Site

沙中綫工地範圍  
SCL Works Site

分域碼頭街行人改道  
Diversion for pedestrian  
on Fenwick Pier Street

附圖二  
Fig.2

灣仔北及中環及灣仔繞道隧道(西行)交通安排 -  
由2021年11月28日凌晨3時起至上午6時止  
Traffic Arrangements in Wan Chai North and Central-Wan Chai Bypass Tunnel Westbound -  
From 3.00 am to 6.00 am on 28 November 2021

